

NOTE:  
This drawing only shows internal floor space. balconies are shown on general arrangement plans and areas depicted on HQA

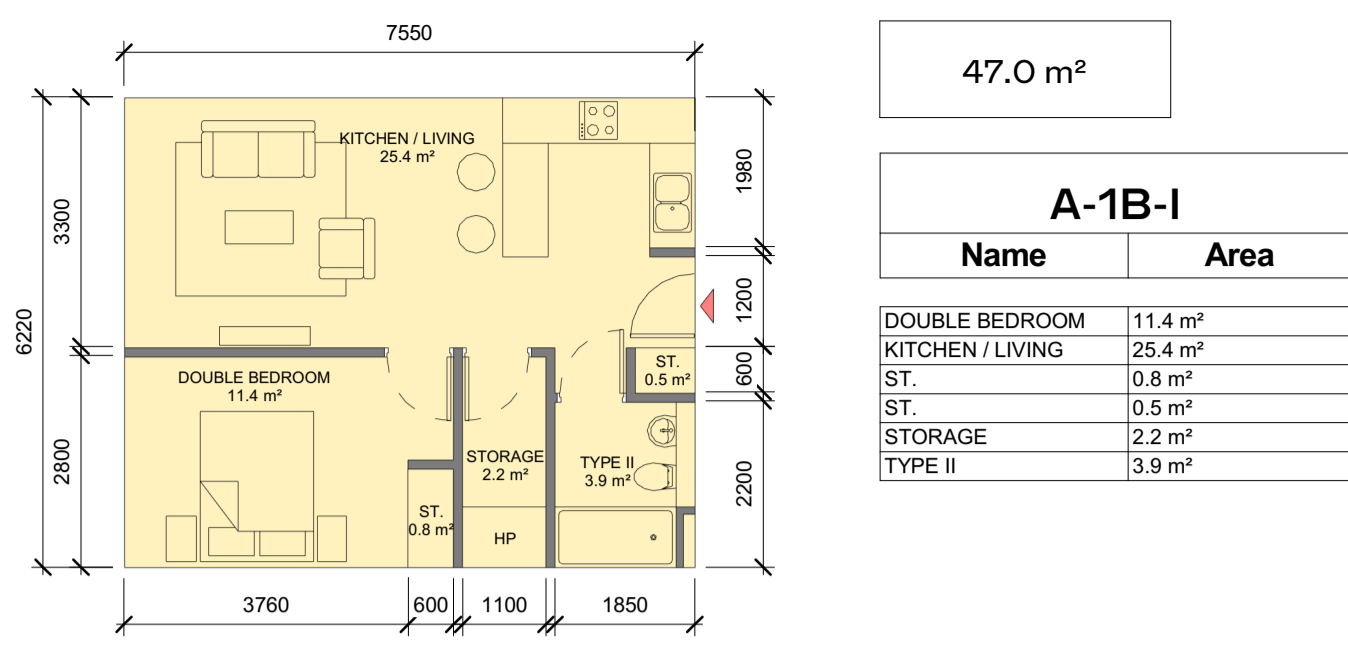

47.0 m<sup>2</sup>

A-1B-I	
Name	Area
DOUBLE BEDROOM	11.4 m <sup>2</sup>
KITCHEN / LIVING	25.4 m <sup>2</sup>
ST.	0.8 m <sup>2</sup>
ST.	0.5 m <sup>2</sup>
STORAGE	2.2 m <sup>2</sup>
TYPE II	3.9 m <sup>2</sup>

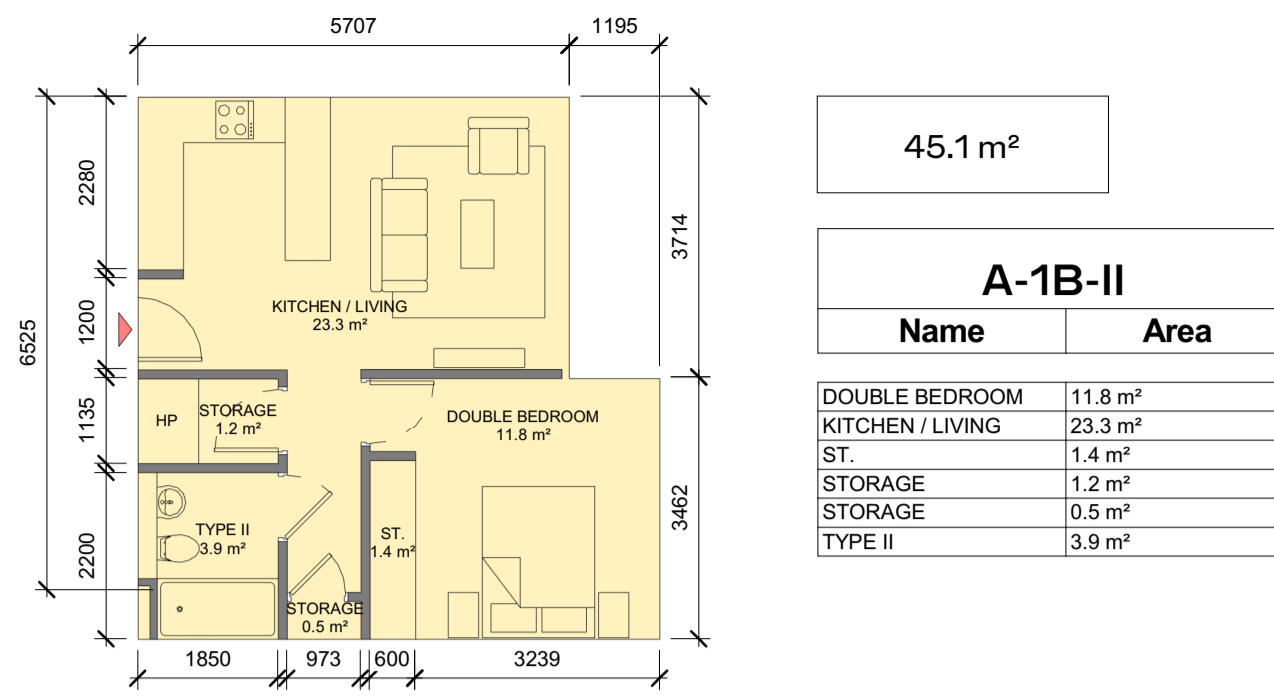

45.1 m<sup>2</sup>

A-1B-II	
Name	Area
DOUBLE BEDROOM	11.8 m <sup>2</sup>
KITCHEN / LIVING	23.3 m <sup>2</sup>
ST.	1.4 m <sup>2</sup>
STORAGE	1.2 m <sup>2</sup>
STORAGE	0.5 m <sup>2</sup>
TYPE II	3.9 m <sup>2</sup>

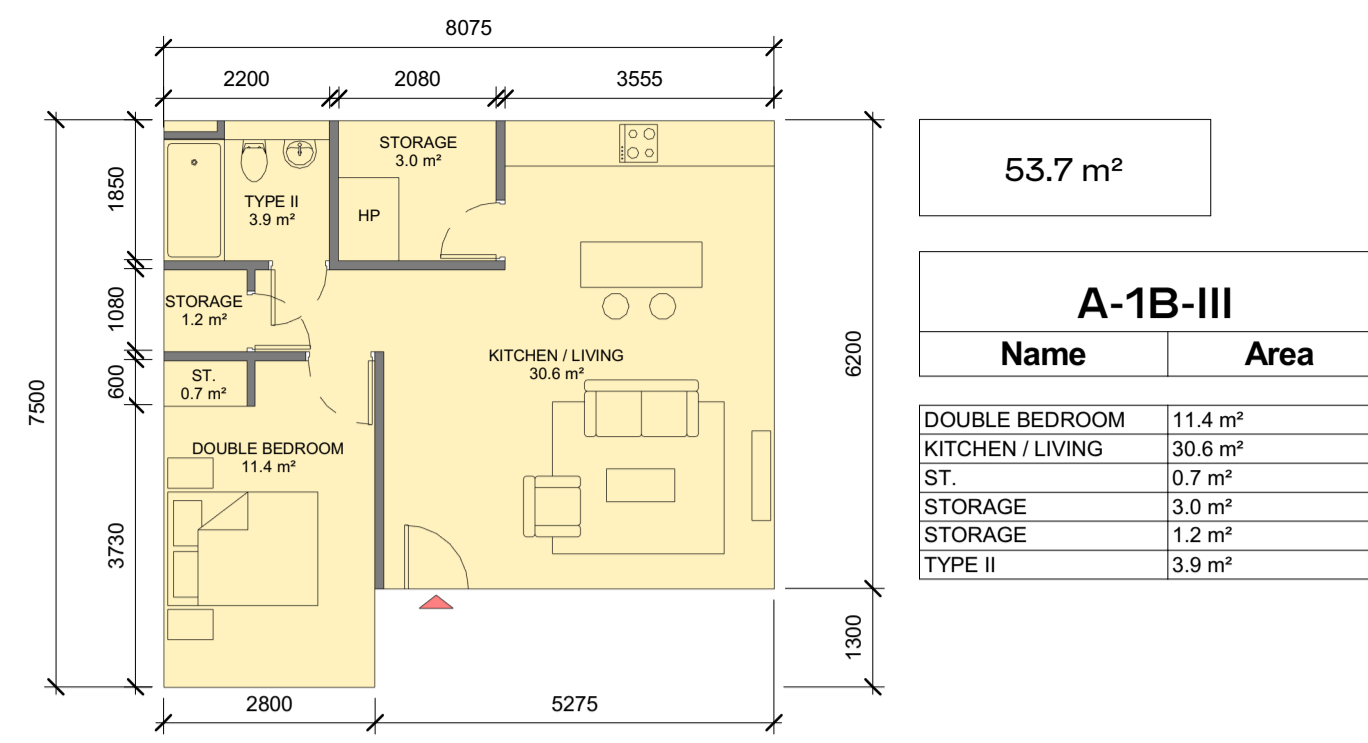

53.7 m<sup>2</sup>

A-1B-III	
Name	Area
DOUBLE BEDROOM	11.4 m <sup>2</sup>
KITCHEN / LIVING	30.6 m <sup>2</sup>
ST.	0.7 m <sup>2</sup>
STORAGE	3.0 m <sup>2</sup>
STORAGE	1.2 m <sup>2</sup>
TYPE II	3.9 m <sup>2</sup>

A-1B-I - SPACE REQUIREMENTS

Apartment Area	Required Apartment Area	Required Area Met	Kitchen - Living Area	Required Kitchen - Living Area	Required Area Met	Total Bedroom Area	Required Total Bedroom Area	Required Area Met	Total Storage Area	Required Total Storage Area	Required Area Met
47.0 m <sup>2</sup>	45.0 m <sup>2</sup>	Yes	25.4 m <sup>2</sup>	23.0 m <sup>2</sup>	Yes	11.4 m <sup>2</sup>	11.4 m <sup>2</sup>	Yes	3.5 m <sup>2</sup>	3.0 m <sup>2</sup>	Yes

4 A-1B-I-2  
1:100

A-1B-II - SPACE REQUIREMENTS

Apartment Area	Required Apartment Area	Required Area Met	Kitchen - Living Area	Required Kitchen - Living Area	Required Area Met	Total Bedroom Area	Required Total Bedroom Area	Required Area Met	Total Storage Area	Required Total Storage Area	Required Area Met
45.1 m <sup>2</sup>	45.0 m <sup>2</sup>	Yes	23.3 m <sup>2</sup>	23.0 m <sup>2</sup>	Yes	11.8 m <sup>2</sup>	11.4 m <sup>2</sup>	Yes	3.1 m <sup>2</sup>	3.0 m <sup>2</sup>	Yes

5 A-1B-II  
1:100

A-1B-III - SPACE REQUIREMENTS

Apartment Area	Required Apartment Area	Required Area Met	Kitchen - Living Area	Required Kitchen - Living Area	Required Area Met	Total Bedroom Area	Required Total Bedroom Area	Required Area Met	Total Storage Area	Required Total Storage Area	Required Area Met
53.7 m <sup>2</sup>	45.0 m <sup>2</sup>	Yes	30.6 m <sup>2</sup>	23.0 m <sup>2</sup>	Yes	11.4 m <sup>2</sup>	11.4 m <sup>2</sup>	Yes	4.9 m <sup>2</sup>	3.0 m <sup>2</sup>	Yes

6 A-1B-III  
1:100

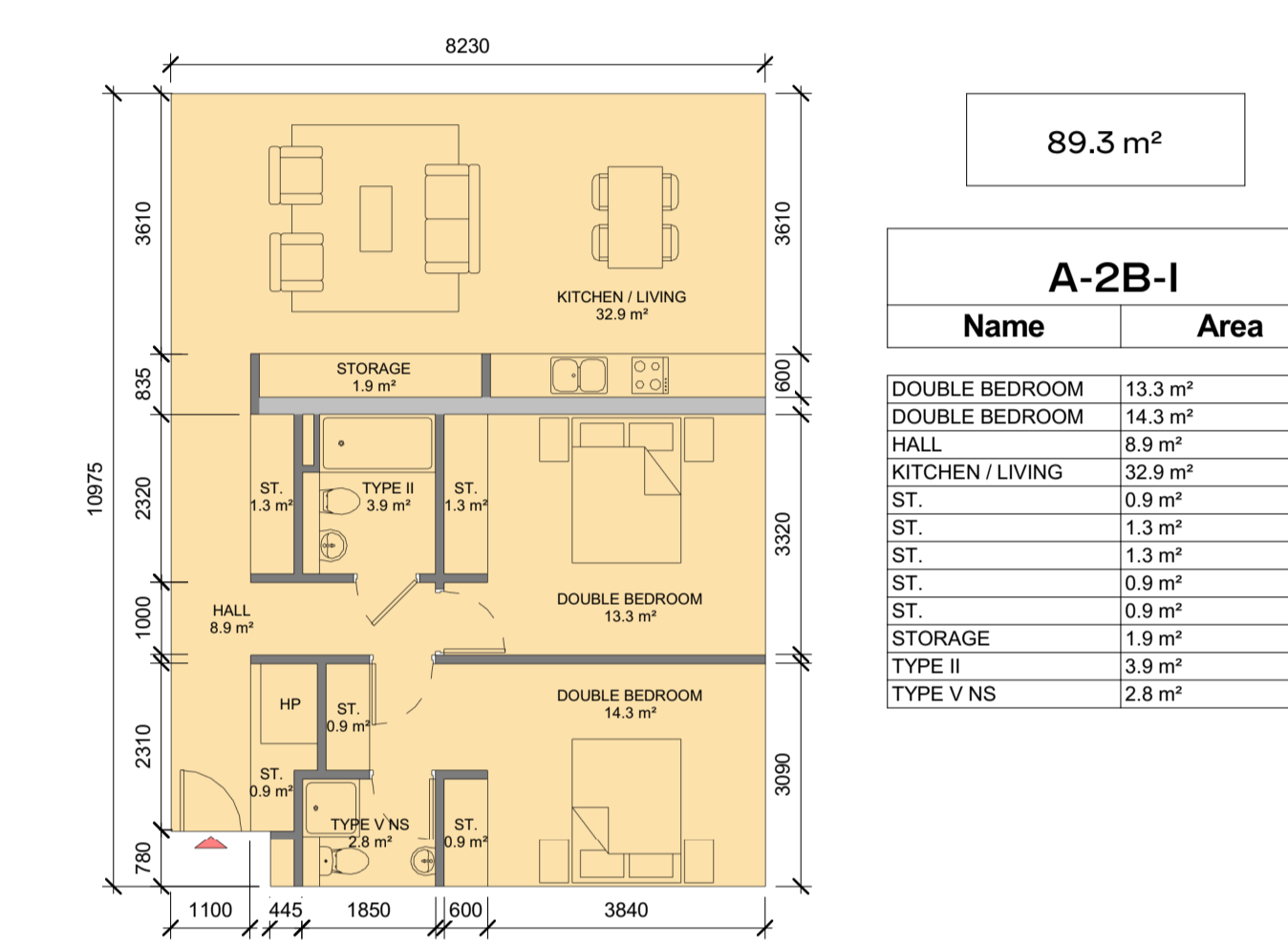

89.3 m<sup>2</sup>

A-2B-I	
Name	Area
DOUBLE BEDROOM	13.3 m <sup>2</sup>
DOUBLE BEDROOM	14.3 m <sup>2</sup>
HALL	8.9 m <sup>2</sup>
KITCHEN / LIVING	32.9 m <sup>2</sup>
ST.	0.9 m <sup>2</sup>
ST.	1.3 m <sup>2</sup>
ST.	1.3 m <sup>2</sup>
ST.	0.9 m <sup>2</sup>
ST.	0.9 m <sup>2</sup>
STORAGE	1.9 m <sup>2</sup>
TYPE II	3.9 m <sup>2</sup>
TYPE V NS	2.8 m <sup>2</sup>

2 A-2B-I  
1:100

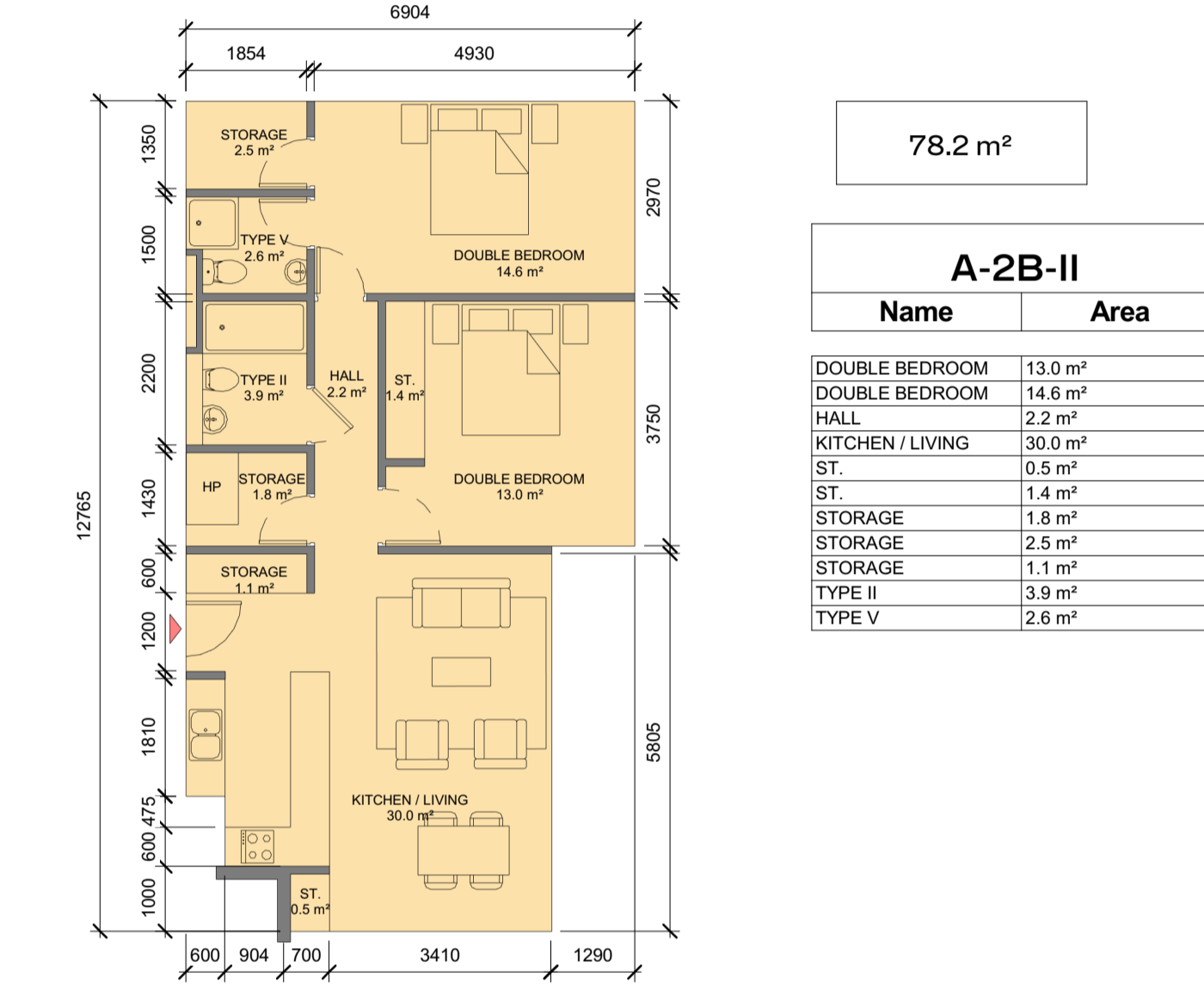

78.2 m<sup>2</sup>

A-2B-II	
Name	Area
DOUBLE BEDROOM	13.0 m <sup>2</sup>
DOUBLE BEDROOM	14.6 m <sup>2</sup>
HALL	2.2 m <sup>2</sup>
KITCHEN / LIVING	30.0 m <sup>2</sup>
ST.	0.5 m <sup>2</sup>
ST.	1.4 m <sup>2</sup>
STORAGE	1.8 m <sup>2</sup>
STORAGE	2.5 m <sup>2</sup>
STORAGE	1.1 m <sup>2</sup>
TYPE II	3.9 m <sup>2</sup>
TYPE V	2.6 m <sup>2</sup>

3 A-2B-II  
1:100

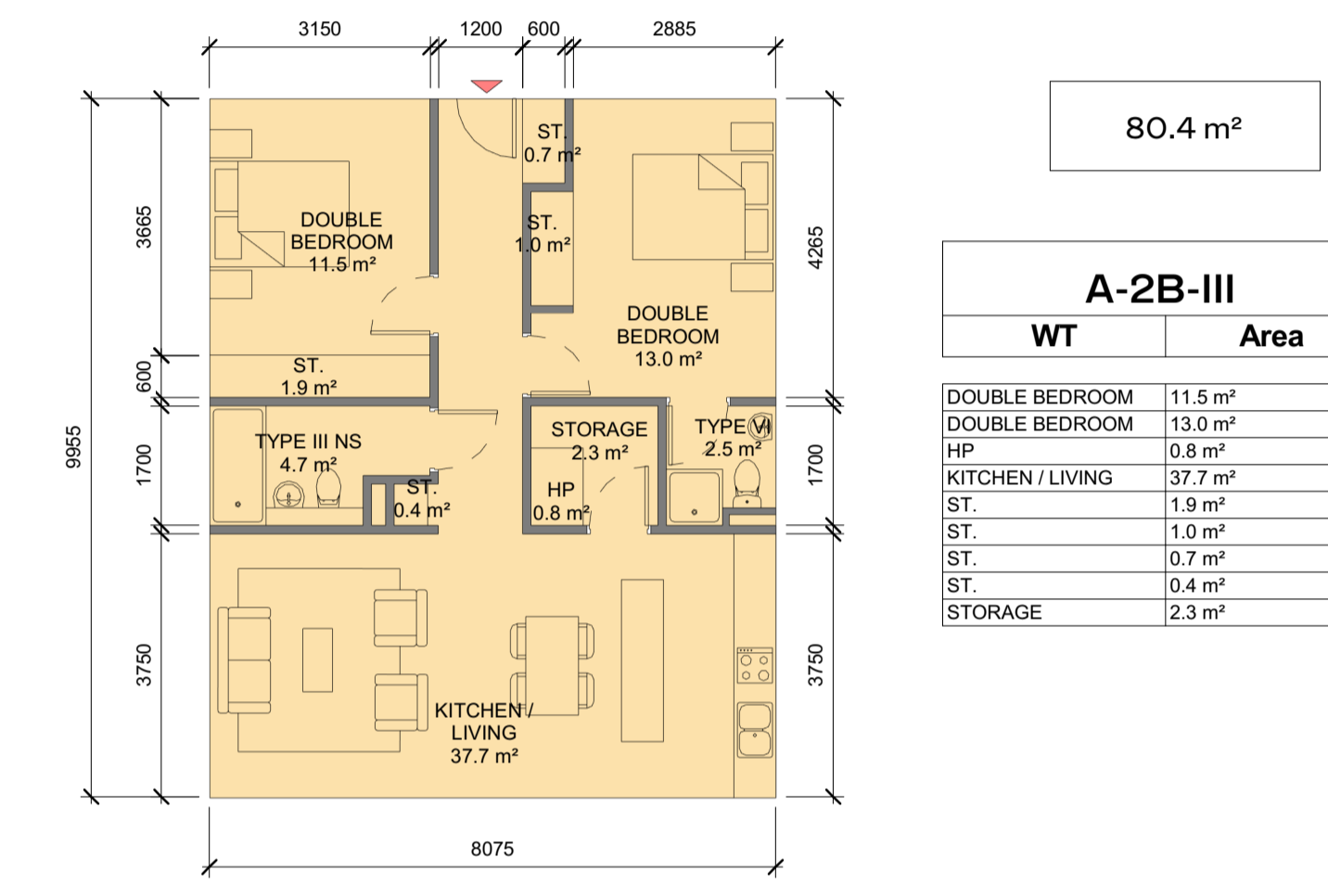

80.4 m<sup>2</sup>

A-2B-III	
WT	Area
DOUBLE BEDROOM	11.5 m <sup>2</sup>
DOUBLE BEDROOM	13.0 m <sup>2</sup>
HP	0.8 m <sup>2</sup>
KITCHEN / LIVING	37.7 m <sup>2</sup>
ST.	1.9 m <sup>2</sup>
ST.	1.0 m <sup>2</sup>
ST.	0.7 m <sup>2</sup>
ST.	0.4 m <sup>2</sup>
STORAGE	2.3 m <sup>2</sup>

8 A-2B-III  
1:100

A-2B-I - SPACE REQUIREMENTS

Apartment Area	Required Apartment Area	Required Area Met	Kitchen - Living Area	Required Kitchen - Living Area	Required Area Met	Total Bedroom Area	Required Total Bedroom Area	Required Area Met	Total Storage Area	Required Total Storage Area	Required Area Met
89.3 m <sup>2</sup>	73.0 m <sup>2</sup>	Yes	32.9 m <sup>2</sup>	30.2 m <sup>2</sup>	Yes	27.6 m <sup>2</sup>	24.4 m <sup>2</sup>	Yes	7.2 m <sup>2</sup>	6.0 m <sup>2</sup>	Yes

A-2B-II - SPACE REQUIREMENTS

Apartment Area	Required Apartment Area	Required Area Met	Kitchen - Living Area	Required Kitchen - Living Area	Required Area Met	Total Bedroom Area	Required Total Bedroom Area	Required Area Met	Total Storage Area	Required Total Storage Area	Required Area Met
78.2 m <sup>2</sup>	73.0 m <sup>2</sup>	Yes	30.0 m <sup>2</sup>	30.0 m <sup>2</sup>	Yes	27.6 m <sup>2</sup>	24.4 m <sup>2</sup>	Yes	7.3 m <sup>2</sup>	6.0 m <sup>2</sup>	Yes

A-2B-III - SPACE REQUIREMENTS

Apartment Area	Required Apartment Area	Required Area Met	Kitchen - Living Area	Required Kitchen - Living Area	Required Area Met	Total Bedroom Area	Required Total Bedroom Area	Required Area Met	Total Storage Area	Required Total Storage Area	Required Area Met
80.4 m <sup>2</sup>	73.0 m <sup>2</sup>	Yes	37.7 m <sup>2</sup>	30.0 m <sup>2</sup>	Yes	24.5 m <sup>2</sup>	24.4 m <sup>2</sup>	Yes	6.2 m <sup>2</sup>	6.0 m <sup>2</sup>	Yes

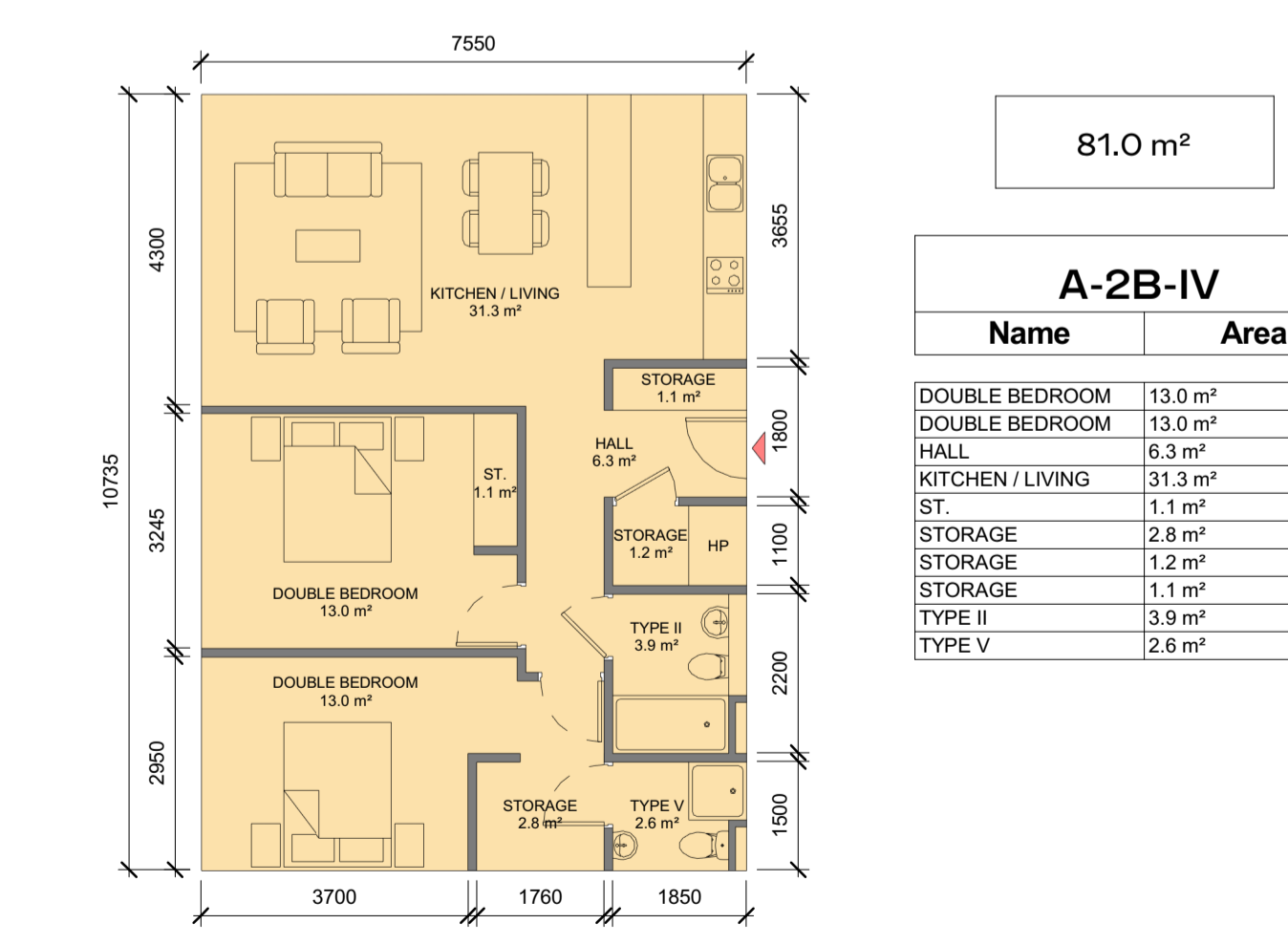

81.0 m<sup>2</sup>

A-2B-IV	
Name	Area
DOUBLE BEDROOM	13.0 m <sup>2</sup>
DOUBLE BEDROOM	13.0 m <sup>2</sup>
HALL	6.3 m <sup>2</sup>
KITCHEN / LIVING	31.3 m <sup>2</sup>
ST.	1.1 m <sup>2</sup>
STORAGE	2.8 m <sup>2</sup>
STORAGE	1.2 m <sup>2</sup>
STORAGE	1.1 m <sup>2</sup>
TYPE II	3.9 m <sup>2</sup>
TYPE V	2.6 m <sup>2</sup>

9 A-2B-IV  
1:100

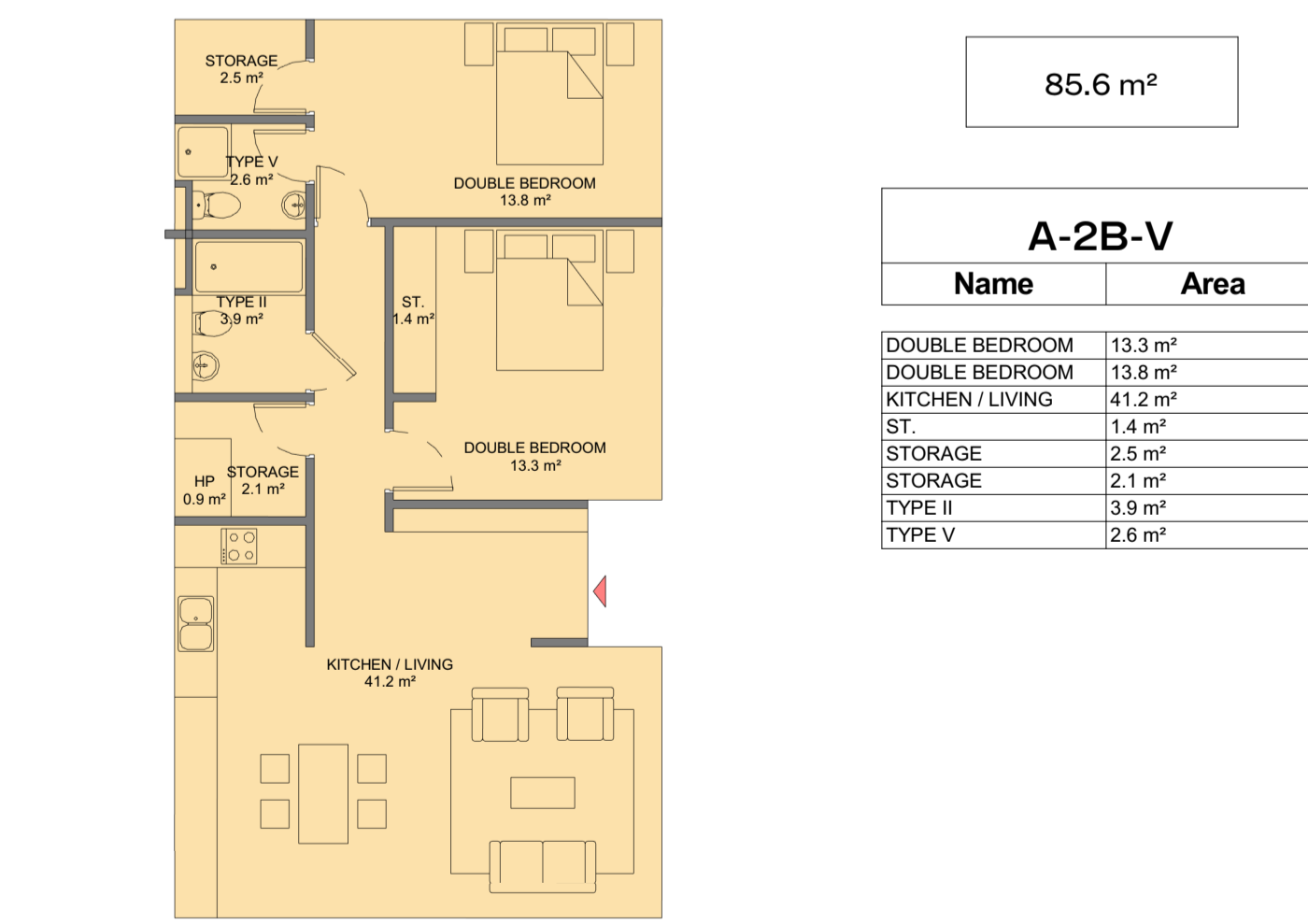

85.6 m<sup>2</sup>

A-2B-V	
Name	Area
DOUBLE BEDROOM	13.3 m <sup>2</sup>
DOUBLE BEDROOM	13.8 m <sup>2</sup>
KITCHEN / LIVING	41.2 m <sup>2</sup>
ST.	1.1 m <sup>2</sup>
STORAGE	2.5 m <sup>2</sup>
STORAGE	2.1 m <sup>2</sup>
TYPE II	3.9 m <sup>2</sup>
TYPE V	2.6 m <sup>2</sup>

10 A-2B-V  
1:100

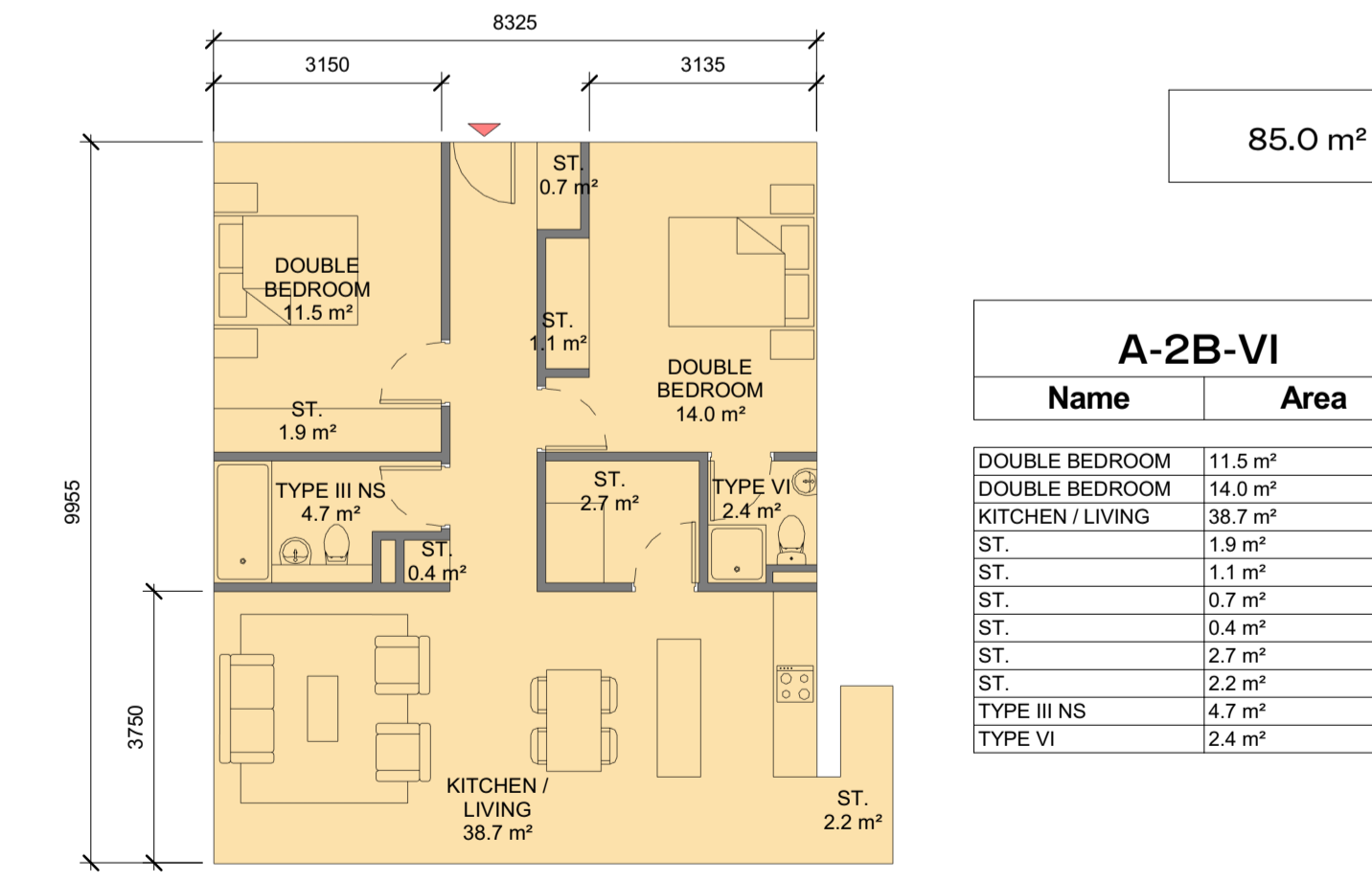

85.0 m<sup>2</sup>

A-2B-VI	
Name	Area
DOUBLE BEDROOM	11.5 m <sup>2</sup>
DOUBLE BEDROOM	14.0 m <sup>2</sup>
KITCHEN / LIVING	38.7 m <sup>2</sup>
ST.	1.1 m <sup>2</sup>
ST.	0.7 m <sup>2</sup>
ST.	0.4 m <sup>2</sup>
ST.	2.7 m <sup>2</sup>
ST.	2.2 m <sup>2</sup>
TYPE III NS	4.7 m <sup>2</sup>
TYPE VI	2.4 m <sup>2</sup>

11 A-2B-VI  
1:100

A-2B-IV - SPACE REQUIREMENTS

Apartment Area	Required Apartment Area	Required Area Met	Kitchen - Living Area	Required Kitchen - Living Area	Required Area Met	Total Bedroom Area	Required Total Bedroom Area	Required Area Met	Total Storage Area	Required Total Storage Area	Required Area Met
81.0 m <sup>2</sup>	73.0 m <sup>2</sup>	Yes	31.3 m <sup>2</sup>	30.0 m <sup>2</sup>	Yes	26.0 m <sup>2</sup>	24.4 m <sup>2</sup>	Yes	6.2 m <sup>2</sup>	6.0 m <sup>2</sup>	Yes

A-2B-V - SPACE REQUIREMENTS

Apartment Area	Required Apartment Area	Required Area Met	Kitchen - Living Area	Required Kitchen - Living Area	Required Area Met	Total Bedroom Area	Required Total Bedroom Area	Required Area Met	Total Storage Area	Required Total Storage Area	Required Area Met
85.6 m <sup>2</sup>	73.0 m <sup>2</sup>	Yes	41.2 m <sup>2</sup>	30.0 m <sup>2</sup>	Yes	26.9 m <sup>2</sup>	24.4 m <sup>2</sup>	Yes	6.0 m <sup>2</sup>	6.0 m <sup>2</sup>	Yes

A-2B-VI - SPACE REQUIREMENTS

Apartment Area	Required Apartment Area	Required Area Met	Kitchen - Living Area	Required Kitchen - Living Area	Required Area Met	Total Bedroom Area	Required Total Bedroom Area	Required Area Met	Total Storage Area	Required Total Storage Area	Required Area Met
85.0 m <sup>2</sup>	73.0 m <sup>2</sup>	Yes	38.7 m <sup>2</sup>	30.0 m <sup>2</sup>	Yes	25.5 m <sup>2</sup>	24.4 m <sup>2</sup>	Yes	8.9 m <sup>2</sup>	6.0 m <sup>2</sup>	Yes

REV	DATE	DESCRIPTION	CHK	DRN
A2	15.11.2019	ISSUED FOR PLANNING APPROVAL	RJ	HIL
A1	18.07.2019	ISSUED FOR ABP PRE-APPLICATION	RI	BM

STATUS CODE DESCRIPTION  
**ISSUED FOR PLANNING APPROVAL**

CLIENT  
SANDYFORD GP Ltd.

PROJECT  
SANDYFORD CENTRAL

DRAWING  
PROPOSED APARTMENTS BLOCK A

PROJECT NUMBER  
950572

DATE  
18/07/2019

SCALE@ A1:  
1: 100

DRAWN/CHECKED:  
SR/ SR

REVISION  
A2 SFC-HJL-XX-ZZ-DR-A-8100

DRAWING NUMBER  
A1

STATUS CODE:  
A1

**Henry J Lyons**

Architecture + Interiors  
henryjlyons.com

+353 1 889 3333  
info@henryjlyons.com

51-54 Pearse Street  
Dublin D02 K466